



DESCRIPTION

The Sanlorenzo SD90 is a luxury motor yacht designed to provide the highest standards of liveability with new solutions introduced both externally and internally that give a totally revised perception of space.

The exterior design, penned by the Zuccon International Project studio, is the result of a complex stylistic research that finds a perfect balance in the shapes and volumes.

The interior design of the Sanlorenzo SD 90 is curated by Patricia Urquiola who interprets the spaces, bringing her own vision on board with an approach closely linked to transformability.

This Sanlorenzo SD 90 accommodates 6 guests in 3 cabins. The Owner stateroom in the main deck forward, two VIP cabins in the lower deck amidship and also have a family room with a private bathroom that can be convertible in a twin cabin or double cabin with an extra pullman bed. All cabins are ensuite.

Marco Fiorani

+33 6 40 62 37 95 - marco@ideayachting.com

MALTA | MONACO

SPECIFICATIONS

Builder	Sanlorenzo
Model	SD90
Registration Year	2023
Length	27.43 m
Beam	7.00 m
Draft	1.91 m
Displacement	112 Kg
Propeller type	5 blades NiBrAl "S" class
Engine	2 x 800 Hp MAN I6 D2676LE423, 524 hrs
Generator	Kohler (1 x 35 Kw), Kohler (1 x 28 Kw), 943, 941
Max Speed RPM	14 kn
Cruise Speed RPM	12 kn
Fuel tank capacity Material	13000 l
Water tank capacity Material	2000 l
Waste tank capacity Material	1000 l
Designer	Sanlorenzo Zuccon International Project
Cabins	3 + Family Room
Baths	5
Flag	Malta
Visible	Côte d'Azur, France
Price	7,950,000.00 €
Vat	VAT not Paid

ACCESSORIES

Electronic tools for navigation

Autopilot Simrad
4 Chartplotter Simrad
Compass
Depth Sounder
Display
Electronic engine control

GPS Simrad
Log
Odometer
Radar Simrad
Rudder angle indicator
VHF Radio

Staging and technical

2 Anchor
Anchor Chain Washdown
Automatic Bilge Pump
Batteries
Battery charger 12V 25A for generator
batteries
Bilge Alarm
Bow Thruster
Bow Winches
Courtesy Lights
Deck Shower
Directional Spotlight
Electric Bilge Pump
Electric Windlass
Engine Alarm
Entry door
Fire Extinguishing System
Gangway
Hard top
Horn
Living Room Foldable Table
Manual Bilge Pump

Platform
Saddles for tender
Shorepower connector
Side door
Stabilizers Underway and zero speed
Stern Thruster
Stern Winches
swimming ladder
Teak Cockpit
Teak Side Decks
Tender Garage
Tender Tender Williams Sportjet 435
Twin Steering
4 Underwater lights No.4 Underwater lights
led - no.2 on aft transom + no.2 on hull aft
sides
Voltage Rectifier
Water harbor connector system
Water pressure pump
Winch Electric Foot switch for anchor
windlass

Domestic Facilities onboard

220V Outlets
Air Conditioning Dometic 150000 btu/h
BBQ/Grill
Black Water Tank
Electric Toilet
Heater
Interior wooden floor
Internet Connection Internet Wi-Fi System

4G with harbor hot spot antenna
Inverter
Light Dimmer
Video camera
Warm Water System 150L
Waste Water Plant
Watermaker Idromar 180L/h 414 hours

Entertainment

DTV
Hi-Fi Diamond audio/video package
Satellite TV antenna TV-sat antenna KVH
TV8 - Empty Radome KVH TV8
Speakers

TV Ready
2 TV TV in salon from ceiling with electric
system - TV in VIP cabin from ceiling with
electric system

Kitchen and appliances

Burner
Ceramic hot plate
Deck Refrigerator
Dishwasher
Dryer Miele

Galley
ICE Maker Vitrifrigo IM classic
Oven
Refrigerator
Washer Miele

ACCESSORIES

Freezer

Upholstery

Bow Cushions

Cockpit Cushions

Cushions

Winecooler Miele - Indel Webasto 23 bottles

Fly Bridge Cushions Stern Cushions

Sunshade

FURTHER INFORMATION

Electrical appliances

- Additional battery charger 12V 25A for generator batteries
- Cablemaster – Glendinning CM7 for shore socket 50/63A (only one shore connection)
- Additional waterproof socket 220V no.1 in fly bar cabinet + no.1 on fly helm station (USB)

Alarms and controls

- Advanced electronic fire system
- Panasonic IP CCTV (with DVR): 1 fixed in cockpit, 1 pan & tilt in engine room
- Additional touch screen monitor 12" (ship monitoring system) in crew mess

Electronics

- Additional fixed control station in aft cockpit
- Simrad Diamond package (diff from Silver std configuration)

Satellite and communication systems (TV Sat)

- TV-sat antenna KVH TV8
- Empty radome KVH TV8

Household appliances

- Wine cooler Miele/Indel Webasto 23 bottles
- Vitrifrigo IM classic ice maker move to galley from pantry
- Teppan yaki on fly bar

Complements for the interior

- Rain shower in VIP and two guest bathrooms
 - Bed frame opening system with pistons (bed storage) in owner and VIP
 - Electric black out shade in VIP (incl. bathroom) and two guest cabins – tot. 4
 - Strip led lighting underneath the bed and night stands in owner and VIP
 - Electric curtain – diff from standard manual system in owner cabin – tot no.4
 - Dimmer package for interiors (guest cabins, bathrooms, galley and wheelhouse)
 - Dimmer package for exterior
 - Patricia Urquiola decor package
-

FURTHER INFORMATION

Complements for the exterior

- External stainless steel shower column on fly
- Sun awning for the stern area of the fly
- Teak floor for flybridge
- Cockpit summer cover (stern area only)
- Sun awning for bow area
- Foot switch for anchor windlass
- No.4 Underwater lights led – no.2 on aft transom + no.2 on hull aft sides
- Additional chain length for 2 anchor lines
- Lateral door in main deck salon on port side
- Teak floor in bow area including the stairs step

Thrusters and stabilizers

- Electric stern thruster

Engine room equipment

- Water maker Idromar 180 l/h
- Boiler 150 liters – diff from 100 liters standard
- Upgrade second generator 35 kW

Audio and video appliances

- Diamond audio/video package – diff from Silver standard configuration
- TV in salon from ceiling with electric system
- TV in VIP cabin from ceiling with electric system
- Internet Wi-Fi System 4G with harbor hot spot antenna

Tender and toys

- Tender Williams Sportjet 435 – 130 hp – Tubes standard white/grey – Upholstery standard white – OPT: single point lift, Led deck lights, overall cover (white)



















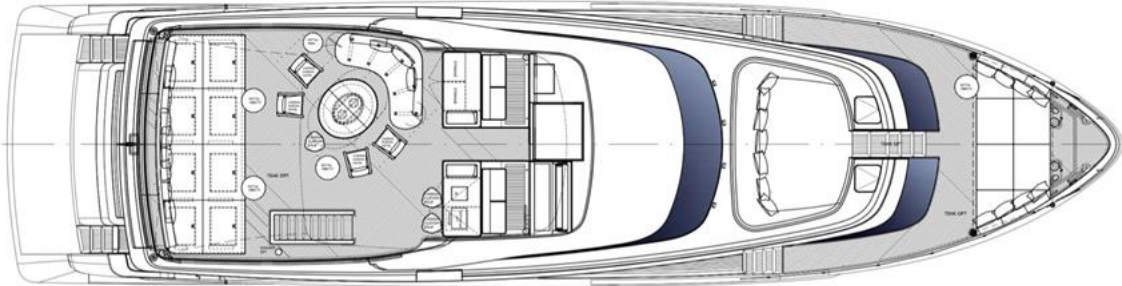

Open table arrangement

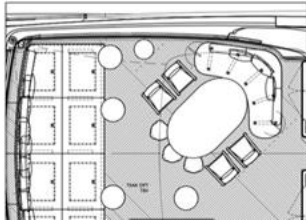

Wheelhouse

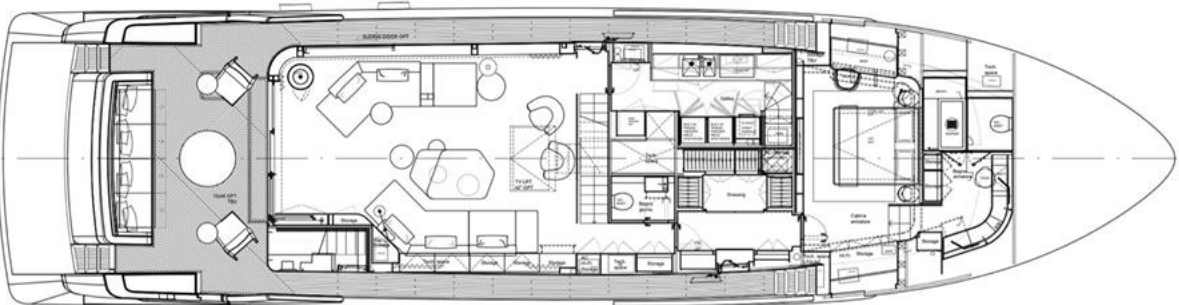

Trasformable dining table

